

THIRD FLOOR PLAN

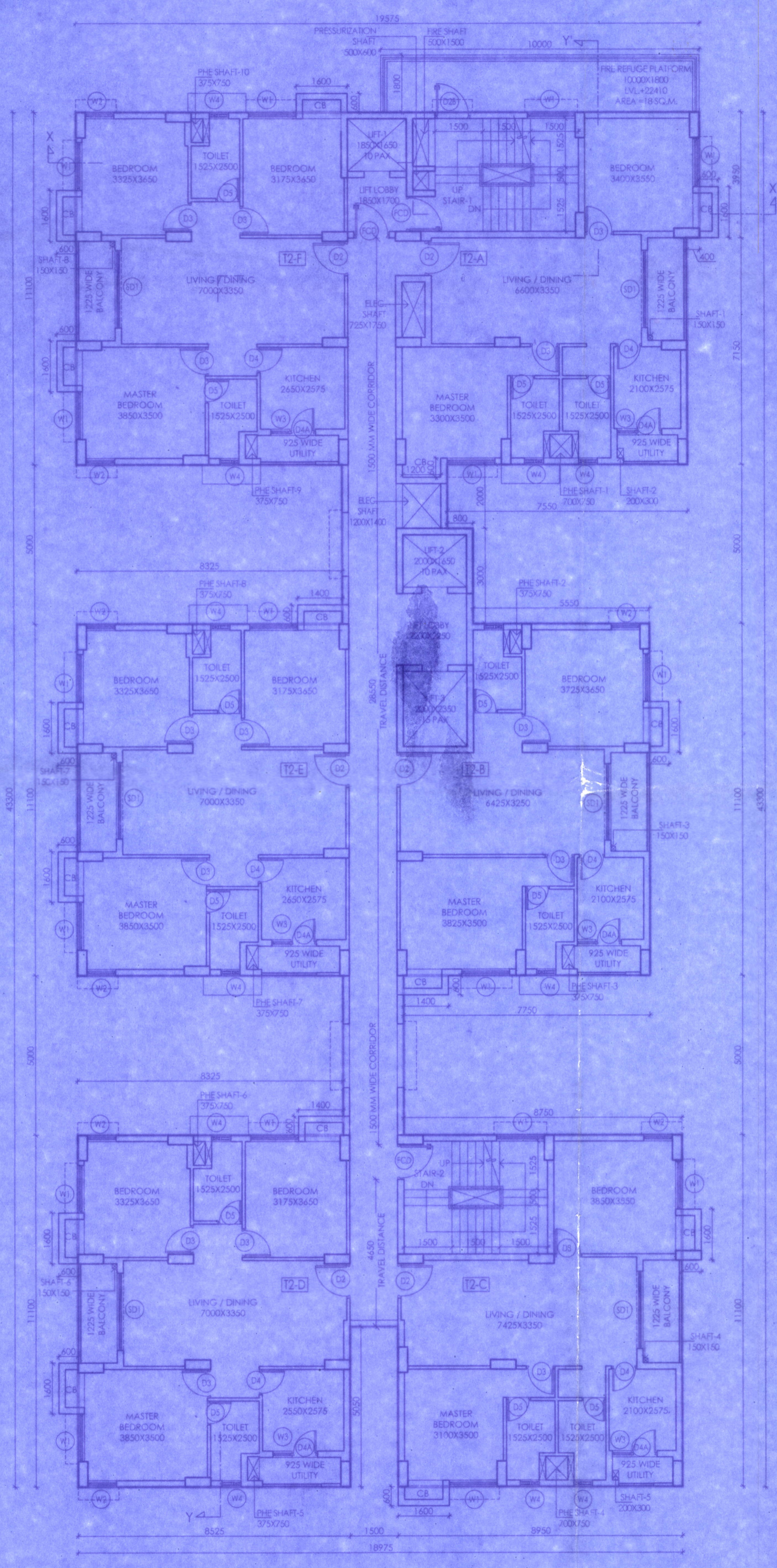

TYPICAL FLOOR PLAN

PROJECT
 PROPOSED 1 NOS. B+G+X STORED & 1NO. B+G+H STORED RESIDENTIAL BUILDINGS.
 ADDRESS: KHAGABARI BESIDE WSEDCI Substation, NH-1, Coocbehari W.B.
 ARCHT: KHAGABARI
 J.L.NO: 89
 SHEET NO: 2
 LR PLAN NO: 13794, 14278
 LR PLOT NO: 2754, 2755, 2756, 2757, 2759, 2760, 2761, 3332, 3333, 3349, 3350, 3351, 3352, 2751, 2647, 2790, 2647, 2648, 2661, 2664, 2668, 2669, 2672, 2685, 2686, 2646, 2749, 2642, 2643 & 2645, 2554
 P.L.: KHAGABARI
 DIST: COOCHBEHAR

GENERAL NOTES
 1. ALL DIMENSIONS ARE IN MM.
 2. ALL EXTERNAL WALLS ARE 200 THK & INTERNAL WALLS ARE 100 THK UNLESS OTHERWISE INDICATED.
 3. ALL MASONRY WORKS ARE BOUND BY CEMENT MORTAR (1:4) & (1:4).
 4. EXTERNAL PLASTER @ 25 THK & INTERNAL PLASTER IS 15MM THK & CEILING PLASTER IS 10MM THK WITH LA WORKER.
 5. ALL CONC. GRADE IS M20.

SCHEDULE OF DOORS			SCHEDULE OF WINDOWS		
NO.	SILL	UNTEL	NO.	SILL	UNTEL
D1	2150	1500X2150	W1	900	2150
D2	2150	1100X2150	W2	900	2150
D2A	2150	1100X2150	W2A	900	2150
D2B	100	2250	W3	1050	2150
D3	2150	900X2150	W4	900	2150
D4	2150	600X2150	W5	300	2400
D4A	2150	600X2150	W5	300	2400
D5	2150	750X2150	W	1500	2150
D5B	2150	2450X2150	CG	AS PER ELEVATION	
PCD	2150	1100X2150			
GD1	2400	1500X2400			
GD2	2400	1000X2400			

UNDERTAKING
 UNDERTAKING HAS INSPECTED THE SITE AND CARRIED OUT SOIL INVESTIGATION THEREON. IT IS CERTIFIED THAT THE EXISTING SOIL OF THE SITE IS ABLE TO CARRY THE LOAD COMING FROM THE PROPOSED CONSTRUCTION AND THE FOUNDATION SYSTEM PROPOSED HEREIN IS SAFE & STABLE IN ALL RESPECT FROM GEO-TECHNICAL POINT OF VIEW.

Rajen Koley
 RAJEN KOLEY
 Civil Technical Engineer, Class-I
 WBC, Emp.No: 401
 Ph. No: 73001-25708 / 90881-45895
 Email: rajenkoley@yahoo.co.in
 SIGNATURE OF GEOTECH ENGINEER

1. I ENGAGED ARCHITECT AND E.S.E. DURING CONSTRUCTION.
 2. I FOLLOWED THE INSTRUCTIONS OF ARCHITECT AND E.S.E. DURING CONSTRUCTION OF THE BUILDING.
 3. I CAN BE RESPONSIBLE FOR STRUCTURE STABILITY OF BUILDING AND ADJOINING STRUCTURE.
 4. IF ANY SUBMITTED DOCUMENT IS FOUND TO BE FAKE THE H.M.C. AUTHORITY MAY REMOVE THE SANCTION PLAN.
 5. THE CONSTRUCTION OF WATER RESERVOIR AND SEPTIC TANK EXECUTED UNDER THE GUIDANCE OF ARCHITECT & E.S.E.
 6. THE GARDEN AREA WILL BE CONSTRUCTED / MADE AND MAINTAINED BY US AT OUR OWN COST.

PRM BEGRAJ VENTURES LLP
 PARTNER
 SIGNATURE OF OWNERS
 PRM BEGRAJ VENTURES LLP
 represented by its Partner SRI UMANG MITAL

THE L.B.A. HAS CERTIFIED ON THE PLAN ITSELF WITH FULL RESPONSIBILITY THAT THE BUILDING PLAN HAS BEEN DRAWN UP AS PER PROVISION OF PLAN CT. BLDG. RULES 2009, AS AMENDED FROM TIME TO TIME AND THAT THE SITE CONDITION INCLUDING THE WIDTH OF THE ABUTTING ROADS CONFORM WITH THE PLAN AND IT IS A BUILDABLE SITE AND NOT A TANK OR PULLED UP TANK.

KARUNAMOY KOLAY
 Regd. Architect
 Regn. No. - CA/2003/32287
 SIGNATURE OF ARCHITECT

THE STRUCTURAL DESIGN OF BOTH FOUNDATION AND SUPERSTRUCTURE OF THE BUILDING HAVE BEEN MADE BY ME CONSIDERING ALL POSSIBLE LOADS INCLUDING THE SEISMIC LOAD AS PER B.C.C. OF INDIA AND CURRENTY. THERE IS SAFE AND STABLE IN ALL RESPECT THE RECOMMENDATION OF SOIL REPORT HAS BEEN CONSIDERED DURING STRUCTURAL DESIGN.

S. A. PAREKH
 M. ARCHT, M.E. CONST. ENGR,
 B.C.E., FIE (F-018202-4)
 E. S. E. No. 104 (I) K. M. G.
 SIGNATURE OF STRUCTURAL ENGINEER

SANJIB GUHA
 BSC, BCE, FIE (F-115554-51)
 CHARTERED ENGINEER
 ENLISTED STRUCTURAL REVIEWER 88/16 K.M.G.
 SIGNATURE OF STRUCTURAL REVIEWER

Pratik Kumar Deb
 CIVIL (B.Tech)
 LBS-I
 Regd. No. - EBM/PW/M-159
 COUNTER SIGNED BY

TITLE: TOWER-2
 THIRD FLOOR & TYPICAL FLOOR PLAN

PRINCIPAL ARCHITECT:
 BEYOND ARCHITECTURE PLANNING
 STUDIO PVT. LTD.
 Regd. Office: 117A/16, SARAT GHOSH
 GARDEN ROAD, KOLKATA - 700031
 www.beyondarchitecture.co.in

DESIGNED BY: SS
 DESIGN CODE ARCHITECTS
 Dibrugarh, Eastern Bypass, Siliguri
 +91 9434035385, +91 9913733330
 d.kode.in@gmail.com

CKD BY: TM

FILE NO: SCALE SHEET NO. DATE
 1:100 10 19.07.2022

SPACE FOR OFFICE USE:

12/04/23
 District Engineer
 Cooc Behar Zilla Parishad
 Cooc Behar

SHEET SIZE - 750X600